

O2 Mk9 Detector Base SET (2057)

O2 Safety System SET with amber Horn/Strobe



TECHNICAL DATA

Power supply:	12-24V DC
Number of sensors:	1-8
Communication:	RS485 Modbus
Automatic calibration:	Several times a year

For further data see separate data sheets for the specific components.

ORDERING EXAMPLE

Item code	Description
2057	O2 Mk9 Detector SET

O2 Mk9 Detector SET consists of:

- Mk9 Central Unit
- Cable red 5m
- O2 Sensor Mk9
- Cable red 10m
- Cable blue 5m
- Horn/Strobe LED amber with 1m cable
- RJ45 1-1 split
- RJ45 1-2 split
- Transformer 1A
- Plug-UL for transformer
- Plug-CE for transformer
- Plug-AU for transformer
- Plug-UK for transformer
- Plug-lock
- Bag with 6 screws and plug
- Sign O2 Safety System Mk9
- Sign Horn/strobe Mk9
- Installation manual O2 Mk9

FUNCTION

The optical LogiCO2 oxygen sensor (O2) has a built-in temperature and pressure adjustment. The oxygen sensor is factory calibrated and measures the ambient oxygen partial pressure (ppO2) levels. The sensor benefits from low power operation and a long lifetime.

The basic O2 Safety System is an instrument comprising one central unit (with a digital display), one (up to eight) sensor unit, one horn/strobe. A separate electronic transformer supplies power to the system. The system provides visible indication of O2 levels and in the area where the remote sensor is located. It is displayed on a screen of the Central Unit in most languages. Explaining what to do in different Alarm situations. The O2 Safety System performs a self-calibration at regular intervals insuring calibration under normal circumstances. This eliminates the need of manual service calibration in a normal environment. A manual start up calibration is however needed.

Installed properly, the O2 sensor will continuously monitor the O2 concentration that it is exposed to. A light emitting diode (LED) indicates that the O2 sensor is running properly. If ambient conditions at the O2 Sensor reach a O2 concentration level below 19.5% (preset evacuation alarm), the central unit will emit a constant audible tone and the « high alarm » red LED lights. A remote Horn/Strobe will flash and sound.

The O2-sensor has a backlit display showing the current O2 concentration and the uptime (measure of operating time) in hours.

ALTITUDE ADJUSTMENT

The LogiCO2 Mk9 O2 sensor has altitude compensation.

O2 Mk9 Detector Base SET (2057)

O2 Safety System SET with amber Horn/Strobe



Connection diagram

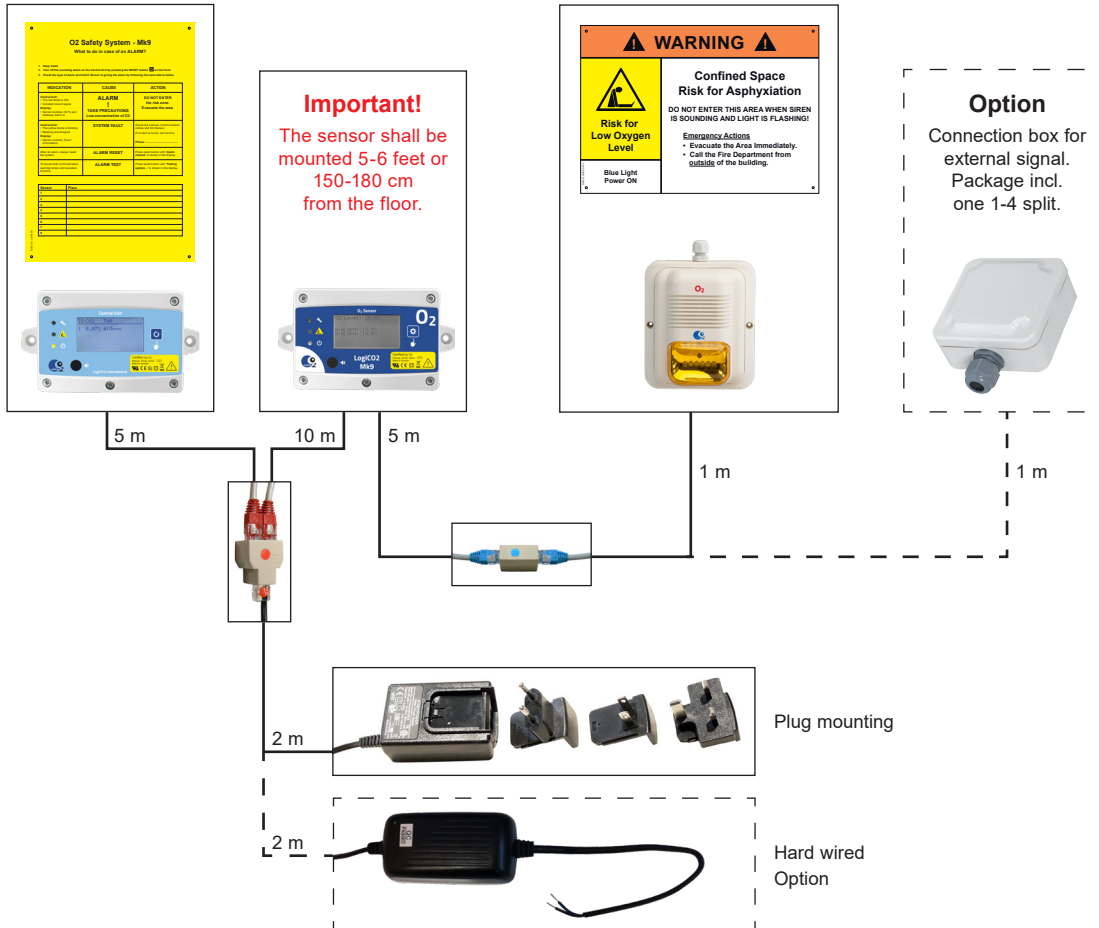

CABLE EXTENSION CONNECTOR

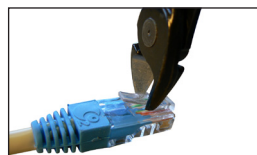
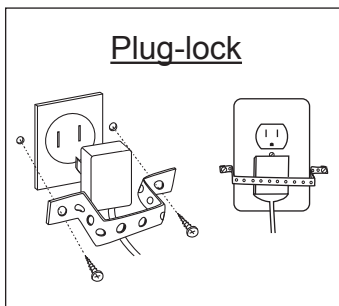
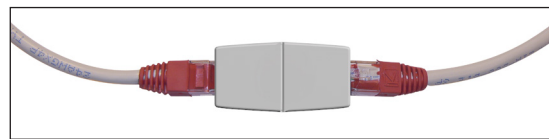
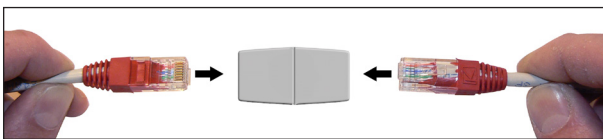

Cut off the prolongations of the lock-release on the RJ45 connectors to secure unauthorized disconnection of the O2 Safety System.

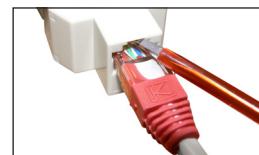

Use a small screwdriver to disconnect the RJ45 plugs.

